

The Sonoma

This model features hinged frame doors and rounded edges designed to be finished in oak or other hard woods. Sizes range from 4 to 12 bottle dispensers with storage space for backup bottles. A self-defrosting, cold-plate style refrigeration system provides quiet, trouble free operation in both the Sonoma and Monterey models.



The Sonoma Includes:

- Two stage regulator
- Lights
- Thermometer
- Thermal-Pane Glass Door
- 8 Ft. Remote Nitrogen tubing with Quick Connect
- Automatic Defrost
- 115 Volts / 60 Hz. & only 1.1 amps Draw
- Temp. Range for White Wines - 42 to 48 F
- Temp. Range for Red Wines - 58 to 64 F
- Minimum required Venting space is 3" behind unit and 12" above.

The Sonoma Specifications and Pricing Guide

Model	Description	# of Reds	# of Whites	Dimensions W" x H" x D"	Weight	Price
4-ORS	4 Bottle Oak	0	4	20.25x27x19.5	85 lb	\$2,475.00
4x2 - ORS	6 Bottle Oak	2	4	30x27x19.5	120 lb	\$3,625.00
4x2 - MRS	6 Bottle Mahogany	2	4	30.13x27x19.5"	"	\$3,575.00
4x4 - O2RS	8 Bottle Oak	4	4	39.5x27x19.5	155 lb	\$4,050.00
4x4 - M2RS	8 Bottle Mahogany	4	4	39.63x27x19.5	155 lb	\$4,625.00
4x4x4 - O2RS	12 Bottle Oak	4	8	58.75x27x19.5	205 lb	\$5,650.00
4x4x4 - M2RS	12 Bottle Mahogany	4	8	"	"	\$6,295.00

*****We match any advertised competitive prices or written estimate of the same products.
Please Call Us for Shipping Quotes & quantity pricing**

Options for the Sonoma

Black	Included
Brass, Chrome Faucet Bonnets	\$ 20.00
Locking Device 4 to 6 Bottles	\$ 350.00
Locking Device 8 to 12 Bottles	\$ 450.00
5 lb Aluminum Nitrogen Cylinder	\$ 200.00 (Dispenses 20-25 Cases)
Keeper Attachment	\$ 24.00
Stopper-Faucet with Stainless Steel wine tube	\$ 56.00

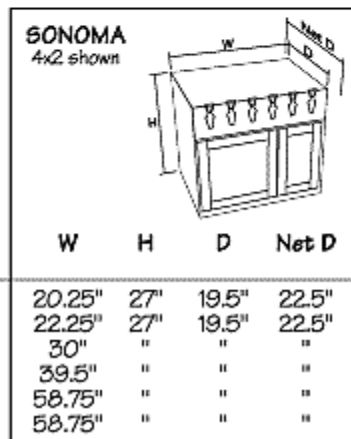
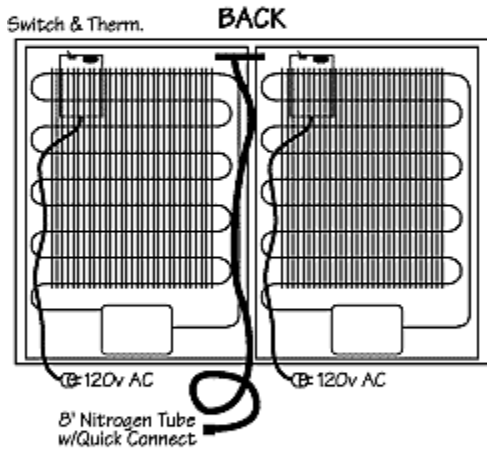
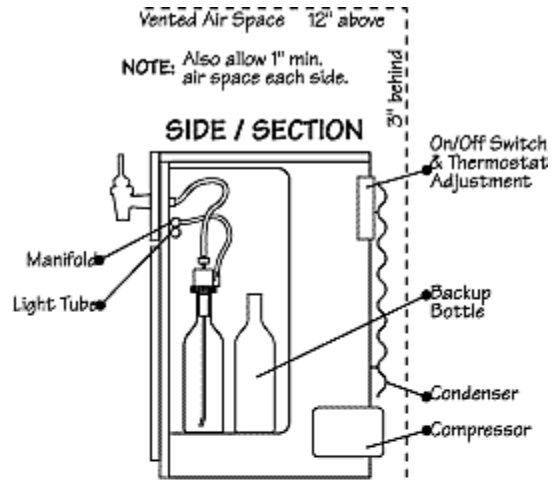
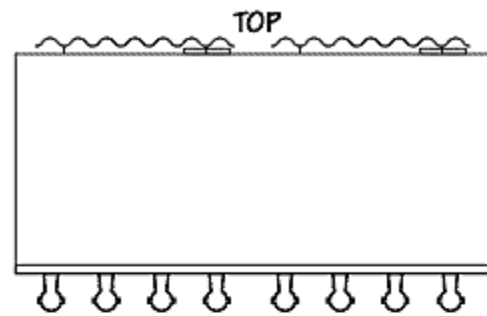

Model	Faucets White/Red	Description	Amps	W	H	D	Net D	Weight Lbs.
4-	4/0	4 Bottle	.8	20.25"	27"	19.5"	22.5"	85
2x2	2/2	4 Bottle	.8	22.25"	27"	19.5"	22.5"	85
4x2	4/2	6 Bottle	.8	30"	"	"	"	120
4x4	4/4	8 Bottle	.8x2	39.5"	"	"	"	155
4x4x4	8/4	12 Bottle	.8x2	58.75"	"	"	"	190
4x4x4	Vari-Temp	12 Bottle	.8x3	58.75"	"	"	"	190